

N 30, BUILT-IN OVEN, 60 X 60 CM, STAINLESS STEEL B3CCCOAN0B

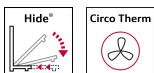

A



Built-in Slide&Hide® oven with fixed handle - unrestricted access to the oven interior thanks to the fully retracting oven door

- ✓ Slide&Hide® – The fully retracting oven door.
- ✓ CircoTherm® – Smart hot-air solution that lets you bake on up to three levels at once.
- ✓ LED-Display - simple, straightforward for clear reading

Features

Technical Data

Construction type: Built-in
Integrated Cleaning system: No
Min. required niche size for installation (HxWxD): 585-595 x 560-568 x 550 mm
Dimensions: 595 x 594 x 548 mm
Dimensions of the packed product (HxWxD): . 660 x 660 x 690 mm
Control Panel Material: Stainless steel
Door Material: Glass
Net weight: 34.8 kg
Usable volume of cavity: 71 l
Cooking method: Full width grill, CircoTherm® gentle, Hot Air, Conventional heat, Hot air grilling
Oven control: mechanical
Number of interior lights: 1
Length of electrical supply cord: 120.0 cm
EAN code: 4242004248705
Number of cavities (2010/30/EC): 1
Energy efficiency rating: A
Energy consumption per cycle conventional (2010/30/EC): 1.04 kWh/cycle
Energy consumption per cycle forced air convection (2010/30/EC): 0.81 kWh/cycle
Energy efficiency index (2010/30/EC): 95.3 %
Connection rating: 2990 W
Fuse protection: 13 A
Voltage: 220-240 V
Frequency: 50; 60 Hz
Plug type: no plug (electrical connection by electrician)
Included accessories: 2 x combination grid, 1 x universal pan



4 242004 248705

Included accessories

2 x combination grid, 1 x universal pan

Optional accessories

Z11AB15A0 Baking tray, non-stick ceramic coated, Z11AU15A0 Universal pan, non-stick ceramic coated, Z11CR10X0 Baking and roasting grid (standard), Z11GT10X3 Glass roasting dish, 5,4l, Z11GU20X0 Glasspan, Z11TI15X0 Cliprails, Z12CL10A0 Lid for professional pan, enamelled, Z12CN10A0 Professional pan, enamelled, Z13CR10X0 Baking and roasting grid (steam), Z13CV05S0 Cover Strip, Z1608BX0 Full ext rails, level independent, Z1650BE0 Half tray, Z1655CA0 Air Fry & Grill tray, Z1913X0 Baking Stone

N 30, BUILT-IN OVEN, 60 X 60 CM, STAINLESS STEEL B3CCCOANOB

Features

Design

- LED Display (Red)
- Elongated designed dials, Retractable control dials, Bevelled oval controls
- Slide&Hide® with fixed handle
- Cavity inner surface: enamel anthracite
- Bar handle
- 4 shelf positions

Features

- Heating up indicator
- Automatic start
- Control panel lock
- Interior halogen light

Cleaning

- Full glass inner door

Programmes/functions

- Oven with 5 main functions heating methods: CircoTherm®, Top/bottom heat, Circo-roasting, Full surface grill, CircoTherm® gentle
- Cooling fan
- Temperature range 50 °C - 275 °C

Accessories

- 2 x combination grid, 1 x universal pan

Performance/technical information

- Cavity volume: 71 litre
- Energy efficiency rating (acc. EU Nr. 65/2014): A
- Energy consumption per cycle in conventional mode: 1.04 kWh
- Energy consumption per cycle in fan-forced convection mode: 0.81 kWh
- Number of cavities: Main cavity Heat source: electrical Cavity volume: 71 litre
- Total connected load electric: 2.99 KW
- 120 cm Cable length
- Nominal voltage: 220 - 240 V
- Appliance dimension (hxwxh): 595 mm x 594 mm x 548 mm
- Niche dimension (hxwxh): 585 mm - 595 mm x 560 mm - 568 mm x 550 mm
- Please refer to the dimensions provided in the installation manual

N 30, BUILT-IN OVEN, 60 X 60 CM, STAINLESS
STEEL
B3CCCOAN0B

Dimensioned drawings

If the appliance will be installed underneath a hob, the following worktop thicknesses (including substructure if necessary) must be taken into account.

Hob type	min. worktop thickness	
	fitted	flush
Induction hob	37 mm	38 mm
Full surface Induction hob	47 mm	48 mm
Gas hob	30 mm	38 mm
Electric hob	27 mm	30 mm

Measurements in mm

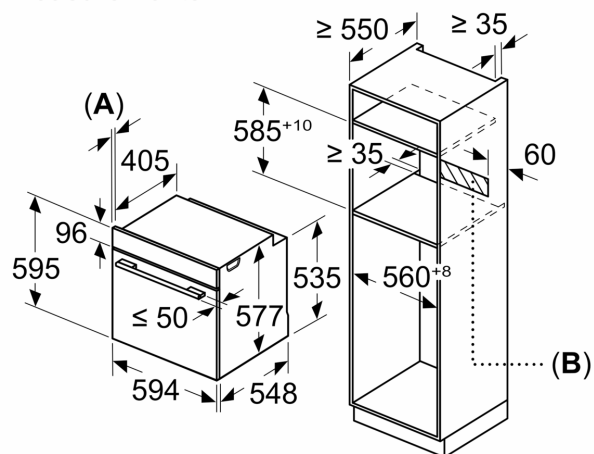

A: 19.5 mm

B: Space for appliance connection 320 x 115 mm

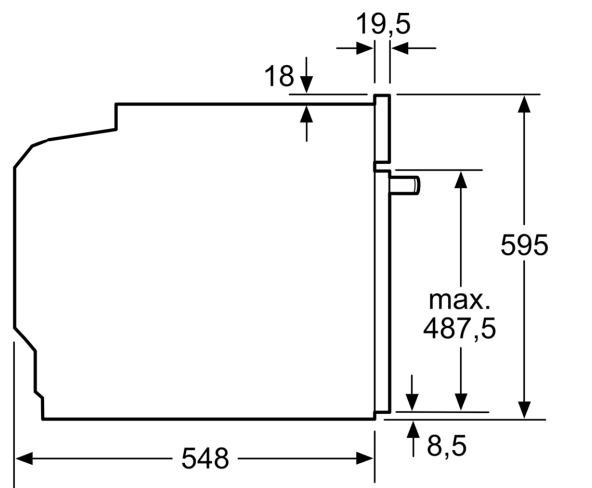
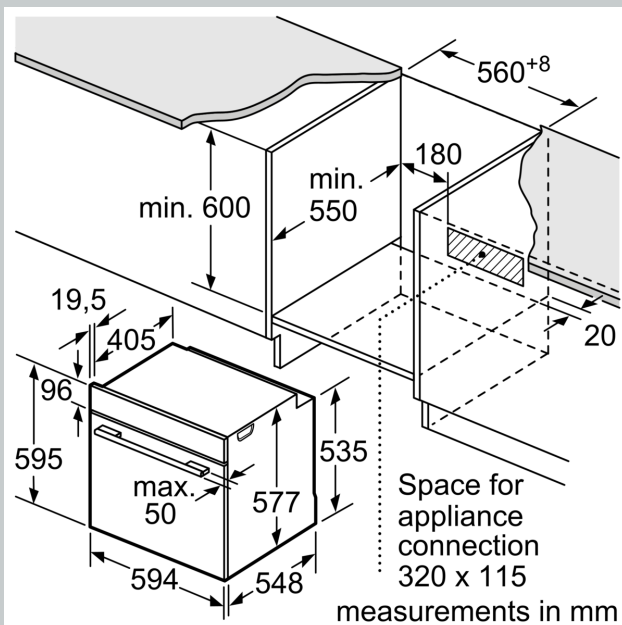

Dimensioned drawings

Installation with a hob.

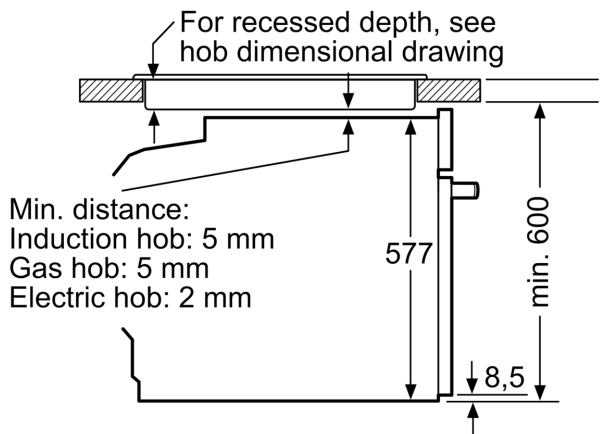

measurements in mm